

TLRAL22HP Fitting Instructions

60x40x3 Acoustic Foam

*Do this if Tough Bar make contact with the front or rear plank of the roof rack.

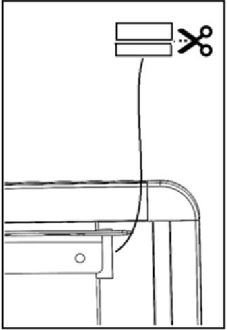



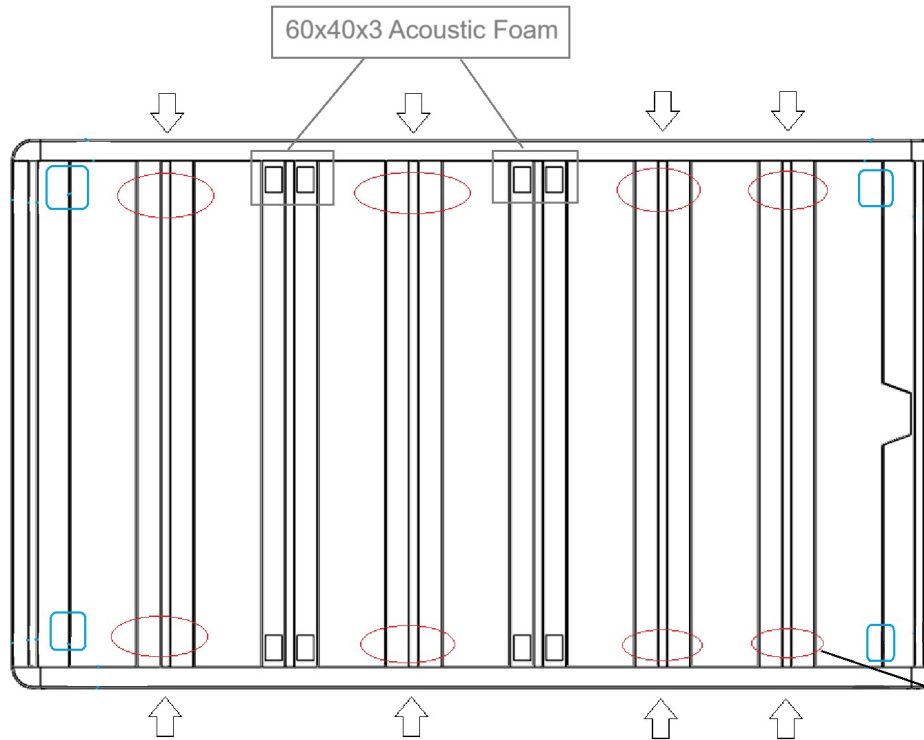

Cut and apply a portion of the acoustic foam tape where the Tough Bar makes contact with front or rear plank of the roof rack

Front

Rear



Legends:

-  Possible contact point between planks and Tough Bar terminal edge
-  Location of M10 Strut Nut and fastener kit
-  Indicating the plank to be secured to the Tough Bar
-  Location of Acoustic Foam Tape

Secure to Tough Bar with :

- M10 x 20 Hex Bolt ----- 8 pcs
- 3/8 x 1 1/4 Flat Washer---- 8 pcs
- M10 Inner Star Washer-- 8 pcs
- 60x40x3 Foam Tape ----- 10 pcs

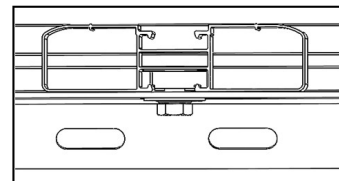
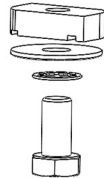

3rd hole from the rear of the Tough Bar

