

TLRAL18HP Fitting Instructions

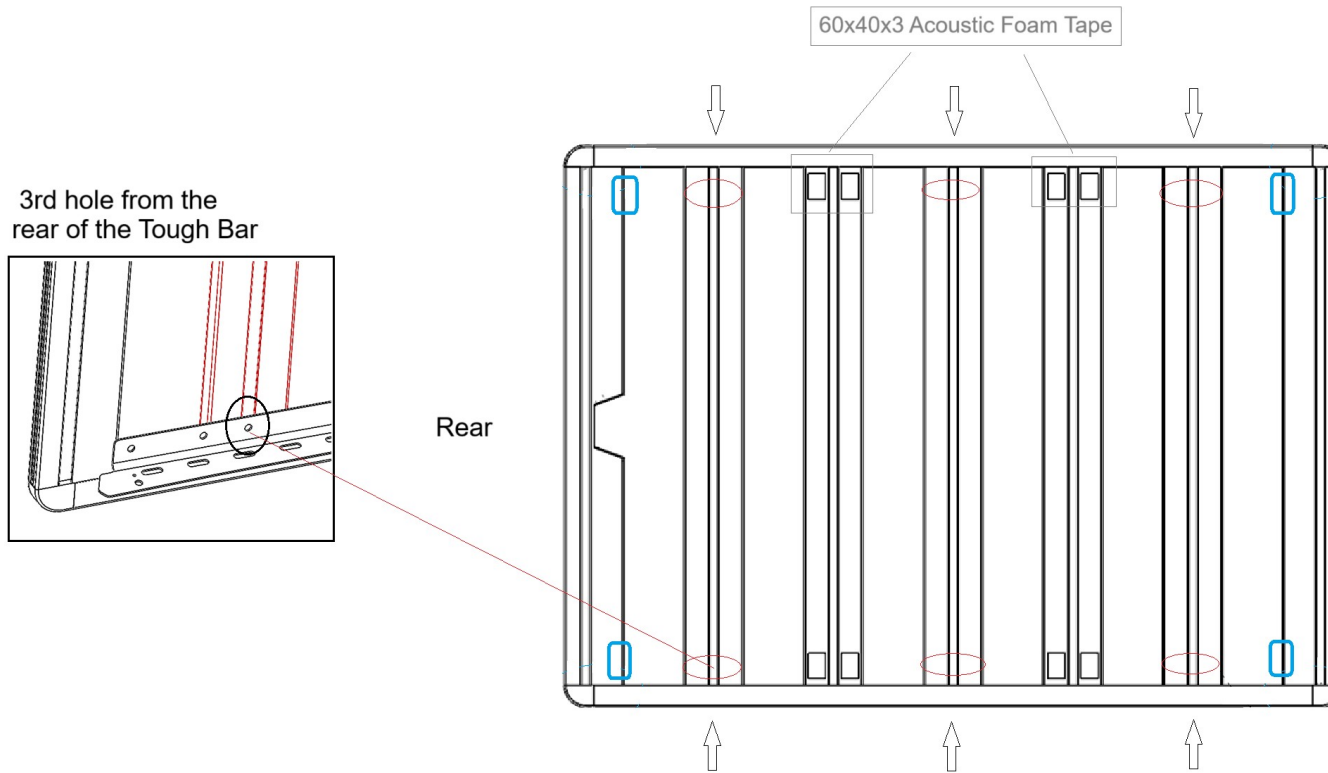

*Do this if Tough Bar make contact with the front or rear plank of the roof rack.

Cut and apply a portion of the acoustic foam tape where the Tough Bar makes contact with front or rear plank of the roof rack

This inset diagram shows a close-up of the contact point between the Tough Bar and the roof rack plank. A pair of scissors is shown cutting a piece of acoustic foam tape. The text below the diagram instructs the user to cut and apply a portion of the acoustic foam tape where the Tough Bar makes contact with the front or rear plank of the roof rack.



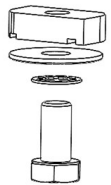

Secure to Tough Bar with :

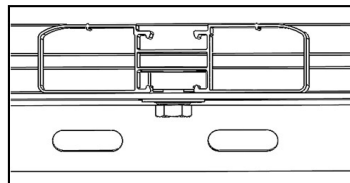

- M10 x 20 Hex Bolt ----- 6 pcs
- 3/8 x 1 1/4 Flat Washer---- 6 pcs
- M10 Inner Star Washer-- 6 pcs
- 60x40x3 Foam Tape ----- 10pcs



Legends:

-  Possible contact point between planks and Tough Bar terminal edge
-  Location of M10 Strut Nut and fastener kit
-  Indicating the plank to be secured to the Tough Bar
-  Location of Acoustic Foam Tape