



## TLRXLB162-03

(Toughbar for Prado 250)

Roof Rack(TLRAL22/FT)

Wind Deflector(TLR76.V5)

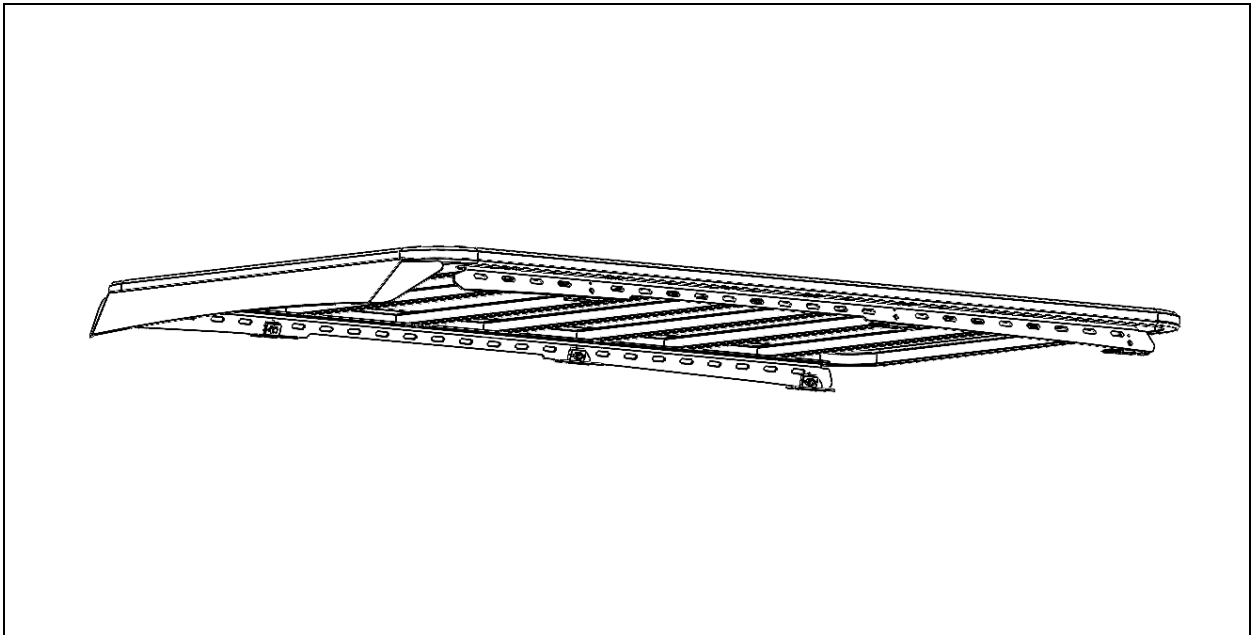

Thank you for purchasing a TRACKLANDER 4WD ROOF RACK. Before you start, take a moment to familiarise yourself with the Fitting Instructions and the components received. Refer to the next section for a list of all the components, quantities and tools required.

## What's inside the box

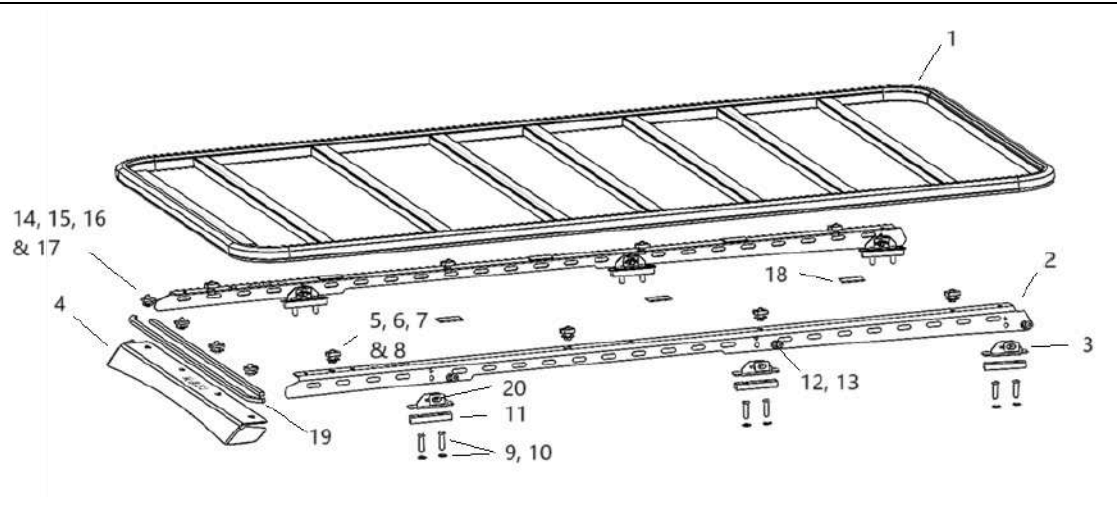

No	Item	Qty
*1	Roof Rack(TLRAL22FT)	1
2	Tough Bar X(Pair-XLB162)	1
3	Angle Brackets, (XAB162)	6
*4	Wind Deflector, (TLR76.V5), includes *14, *15, *16, #17 & #19)	1

Note: Items marked with \* are sold separately

### Fasteners Kit for Tough Bar

5	M10 x 25mm Hex Bolt, S/S	8
6	M10 Star Washer, S/S	8
7	$\frac{3}{8}$ x $\frac{1}{4}$ Flat Washer S/S	8
8	M10 Strut Nut	8

### Fasteners for Angle Bracket

9	M8 x 40mm Button Socket Head, SS	12
10	$\frac{5}{16}$ x $\frac{3}{4}$ Flat Washer, SS	12
11	HDPE Spacer Block, (TLRSB72X)	6
12	M10 x 25mm Button Socket Head, SS	6
13	$\frac{3}{8}$ x $\frac{3}{4}$ Flat Washer, SS	6

Fastener Kit for Wind Deflector		
*14	M8 Star Washer, S/S	4
*15	M8 x 25mm Button Cap Socket Head Screw, S/S	4
*16	<sup>5</sup> / <sub>16</sub> X 1 <sup>1</sup> / <sub>4</sub> , Flat washer, S/S	4
*17	M8 Strut Nuts, Z/P	4
Foam Pad		
18	Acoustic Foam Tape, (60x40x3mm) Affix to Toughbar, 3 per side	6
*19	Acoustic Foam Tape, (1100, FS126-9), Affix underneath the front cross member of the Toughbar	2
20	Acoustic Foam Tape for Angle Brackets	6

Note: \*14, \*15, \*16, \*17 & \*19 are provided with Wind Deflector Kit

Tools required
5mm Hexagon Wrench/Key, M8
6mm Hexagon Wrench/Key, M10
Size 10mm Socket for M6 Hex Bolt
Size 12mm Socket for M8 Hex Bolt
Size 17mm Spanner for M10 Hex Bolt
Measuring Tape
Plastic Pry Tool

Recommended Torque Setting for fasteners	
M6	
M8	
M10	

**Step 1: Removal of factory fitted Roof Rail from the roof of the vehicle**



- With the aid of a pry tool, remove the front and rear Rail Cover.
- To remove the centre cover, rest your fingers both sides on the rear of the centre cover and pull it toward you simultaneously.



- Once the M8 Hex Bolts are exposed, loosen them with a size 12 socket.

**Warning:**

\*Do not use a rattle gun to remove the hex bolts as the factory fitted brackets underneath the roof may disengage from their locations.

**Lift & remove the factory fitted Roof Rail**



Remove the bolts with a size 10mm socket



Remove the centre bracket

**Note:**

Before proceeding with the installation process, remove all foreign particles from the exposed ditches using a vacuum cleaner.

You may spray some mild detergent before wiping dry with a clean cloth.

## Step 2: Installation of Angle Brackets

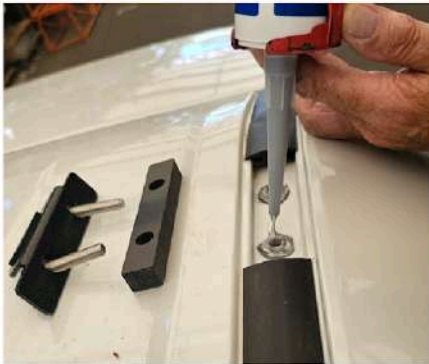

Apply silicon liberally around the mounting hole plastic sleeves



With the fasteners in place in the Angle Bracket and HDPE Spacer Block, apply silicon around the protruding ends of the fasteners. (M8 x 40mm Button Cap Socket Head Screw)



Holding the HDPE and Spacer Block, guide the Angle Bracket Assembly into the mounting holes

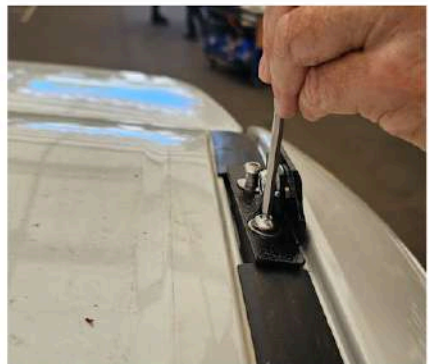

Lightly tighten the assembly to allow for adjustment of the Angle Bracket. Once that is done, pull the Angle Bracket toward you.

\*Repeat for the remaining Angle Brackets.



Use the straight edge of the Tough Bar to align the 3 sets of Angle Brackets in a straight line by pushing them toward the centre of the vehicle.

Once they are in position, secure the Angle Brackets firmly using a 5mm Hex Allen Wench.

**Step 2: Setting up of Tough Bars onto the Roof Rack**

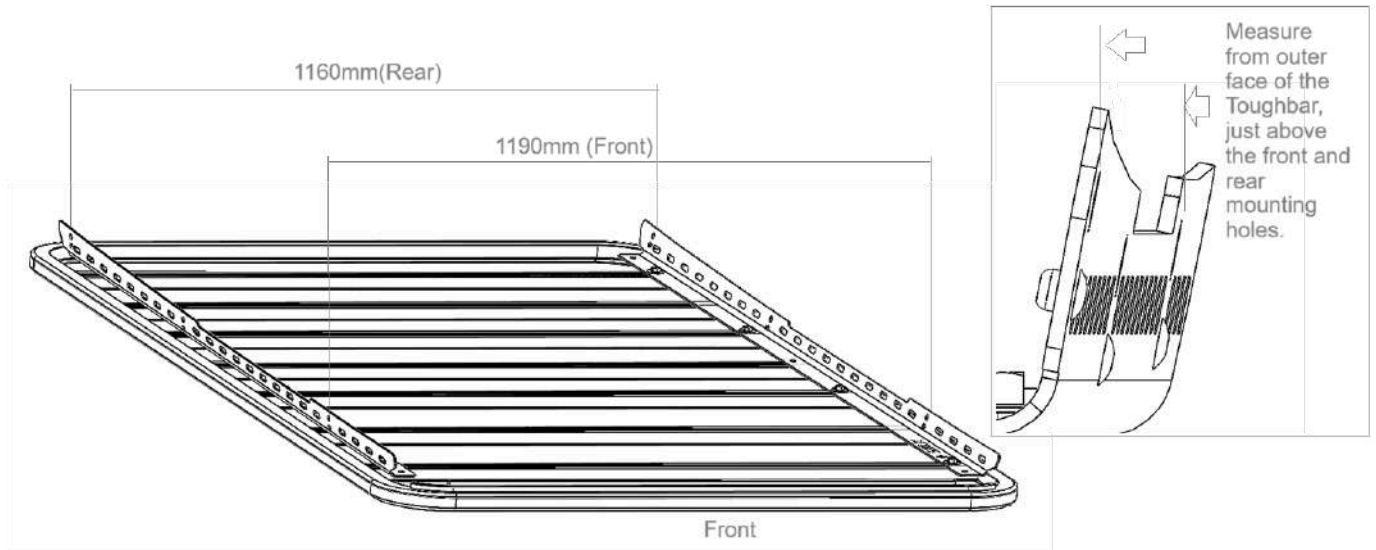

Centralized the Toughbar on the Roof Rack before securing them with the M10x25mm Hex Bolts, Star Washer, Flat Washer and Strut Nut

\*Remember to place the  $\frac{3}{8}$  x  $1\frac{1}{4}$  Flat Washer and M10 Star Washer onto the the M10 Hex Bolt..



**Step 3: Install the Wind Deflector (TLR76.V5)**

- Apply Acoustic Foam Tape onto the front of Roof Rack (Underside, Rear Lip of the channel + Base Frame Tube)

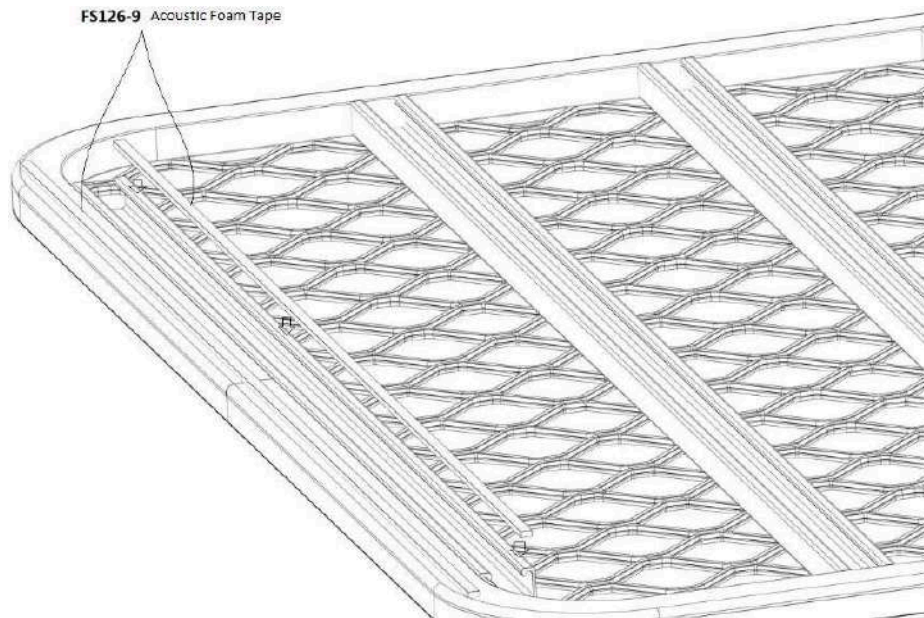

- Secure the Wind-deflector onto the front of the rack as per the illustration shown below:

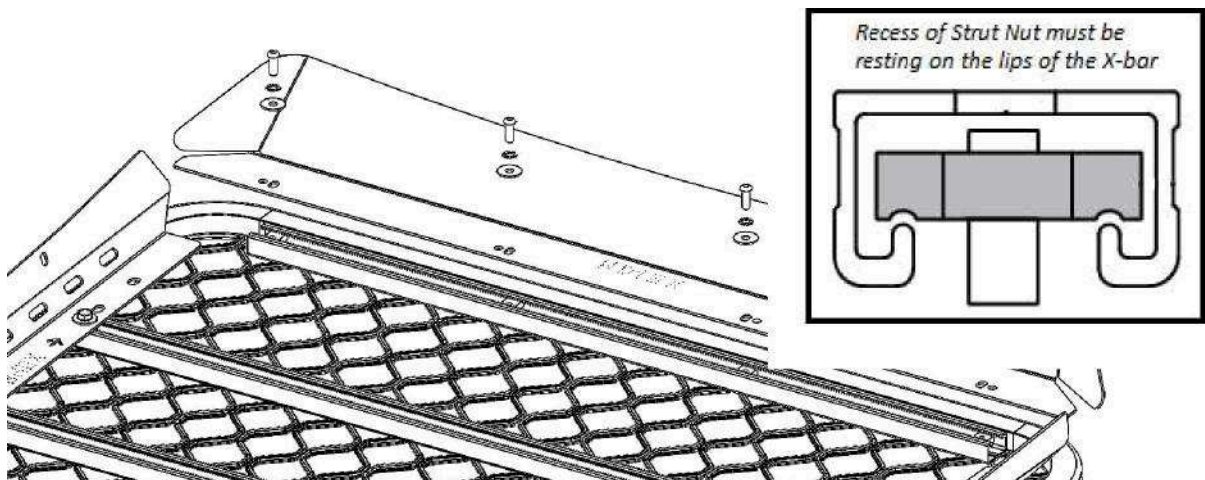

- Centralise and tighten.

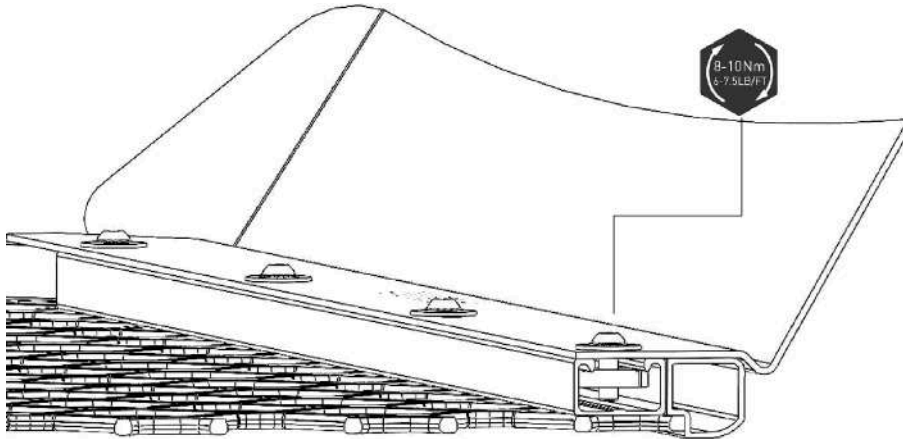

\*Wind Deflector fitted to the front channel.

### Step 7: Installation of Roof-rack assembly onto the vehicle

- With 2 people either side of the Roof Rack, carry the Roof Rack over the rear of the vehicle, rest the Tough Bar gently over the Angle Brackets previously installed on the roof of the vehicle and align the mounting holes.



- Fit M10 x 25mm Button Socket Screws with Flat Washers through Tough Bar Holes and secure to Angle Bracket Sliding Nut.
- Tighten all the M10x25mm Button Socket Screws to secure the Roof Rack assembly firmly in place according to the sequence illustrated.

- The installation is now completed and ready to be used.
- Check to ensure that all fasteners are fully secured.



### Final Check & Tightening Procedure

\* Follow the tightening sequence as shown below:

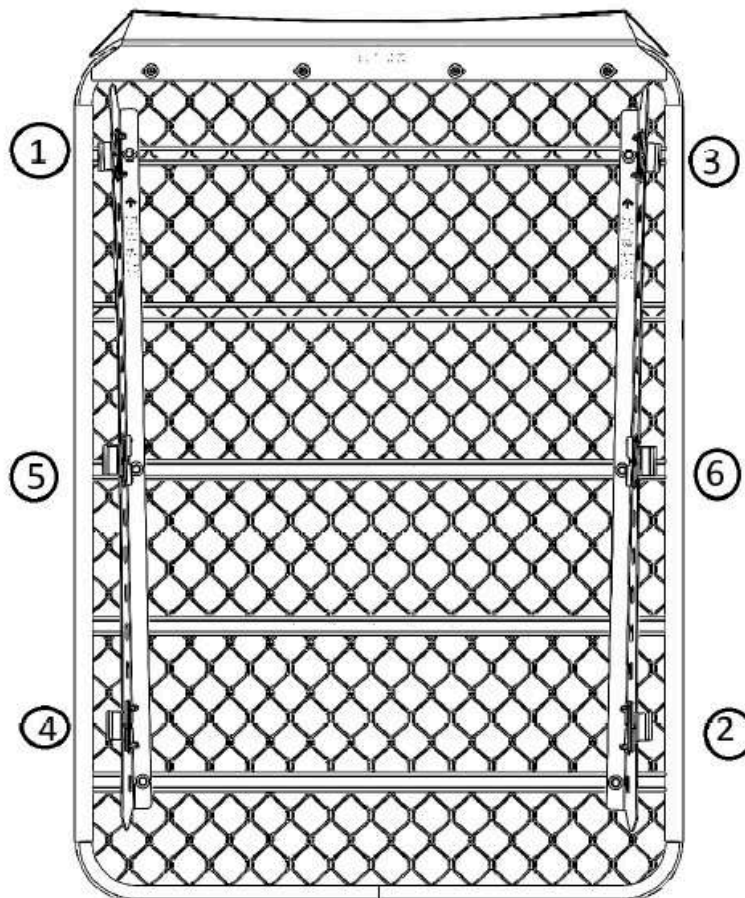

## SAFETY

- Cargo must be secured firmly onto the Roof Rack during operation at all times.
- Frequently check the tightness of cargo on the Roof Rack, especially when travelling over rough terrain or off-road
  - » Use only non-stretchable fastening ropes or straps to attach cargo onto the Roof Rack.
- Extreme care must be taken in off road conditions.

## MAINTENANCE

- All bolted connections should be checked after driving a short distance when you first install your roof racks
- All bolted connections should be checked at regular intervals, depending on road conditions, usage, loads and distances travelled
- All bolted connections should be checked each time they are re-fitted.



### IMPORTANT WARNING!

IT IS CRITICAL THAT ALL TRACKLANDER 4WD ROOF RACK PRODUCTS BE PROPERLY AND SECURELY ASSEMBLED AND ATTACHED TO YOUR VEHICLE. IMPROPER ATTACHMENT COULD RESULT IN AN VEHICLE ACCIDENT, AND COULD CAUSE SERIOUS BODILY INJURY OR DEATH. YOU ARE RESPONSIBLE FOR ASSEMBLING AND SECURING ALL TRACKLANDER 4WD ROOF RACK PRODUCTS TO YOUR VEHICLE, CHECKING THE ATTACHMENTS PRIOR TO USE, AND PERIODICALLY INSPECTING THE PRODUCTS FOR ADJUSTMENT, WEAR AND TEAR. THEREFORE, YOU MUST READ AND UNDERSTAND ALL OF THE INSTRUCTIONS AND PRECAUTIONS SUPPLIED WITH YOUR TRACKLANDER 4WD ROOF RACK AND ACCESSORIES PRIOR TO INSTALLATION OR USE. IF YOU DO NOT UNDERSTAND ALL OF THE INSTRUCTIONS AND WARNINGS, OR IF YOU HAVE NO MECHANICAL EXPERIENCE AND ARE NOT THOROUGHLY FAMILIAR WITH THE INSTALLATION PROCEDURES, YOU SHOULD HAVE THE PRODUCT INSTALLED BY A PROFESSIONAL INSTALLER OR OTHER QUALIFIED PERSON.

NOTE: TRACKLANDER 4WD ROOF RACKS will not be responsible for any damage caused by the failure to install the product according to these instructions. Please call us if you have any questions about the installation of this product.

## TRACKLANDER 4WD ROOF RACKS

T : (08) 9451 0700 E :[sales@tracklander.com.au](mailto:sales@tracklander.com.au) W :[tracklander.com.au](http://tracklander.com.au)  
A:12 Railway Parade, Welshpool, WA 6106  
OPEN 8.00AM - 5.00PM MON-FRI