



Mitsubishi Outlander (MY22 on)

Roof Rack(TLRAL18/FT/OE)

Wind Deflector(TLRWD13X)

TOUGH BAR(XLBKIT147-02)

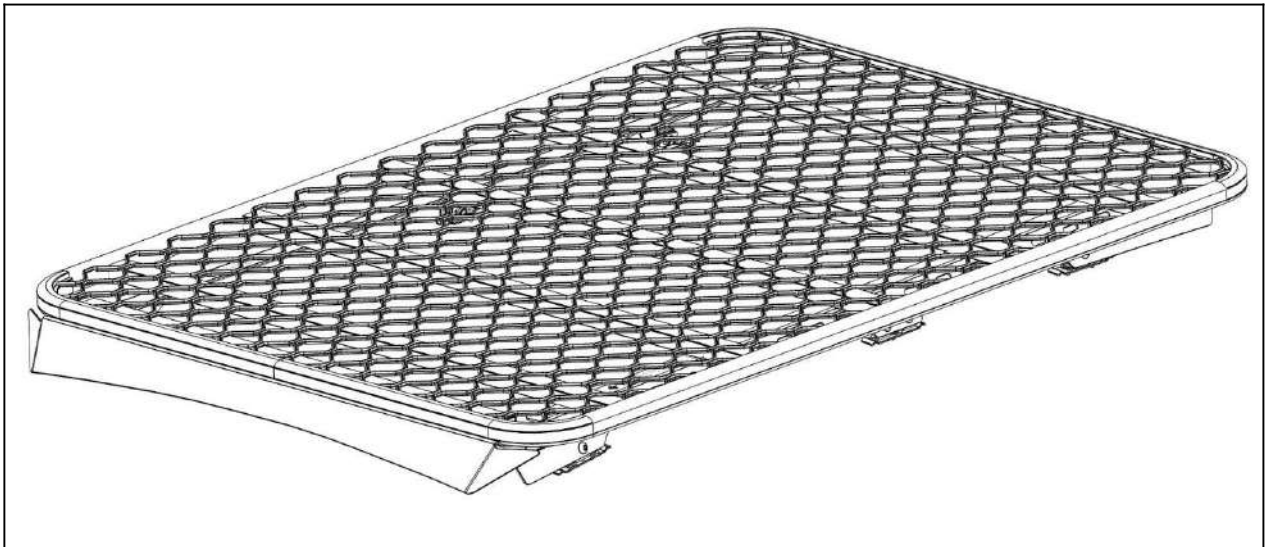

Thank you for purchasing a TRACKLANDER 4WD ROOF RACK. Before you start, take a moment to familiarise yourself with the Fitting Instructions and the components received.

Refer to the next section for a list of all the components, quantities and tools required.

What's inside the box

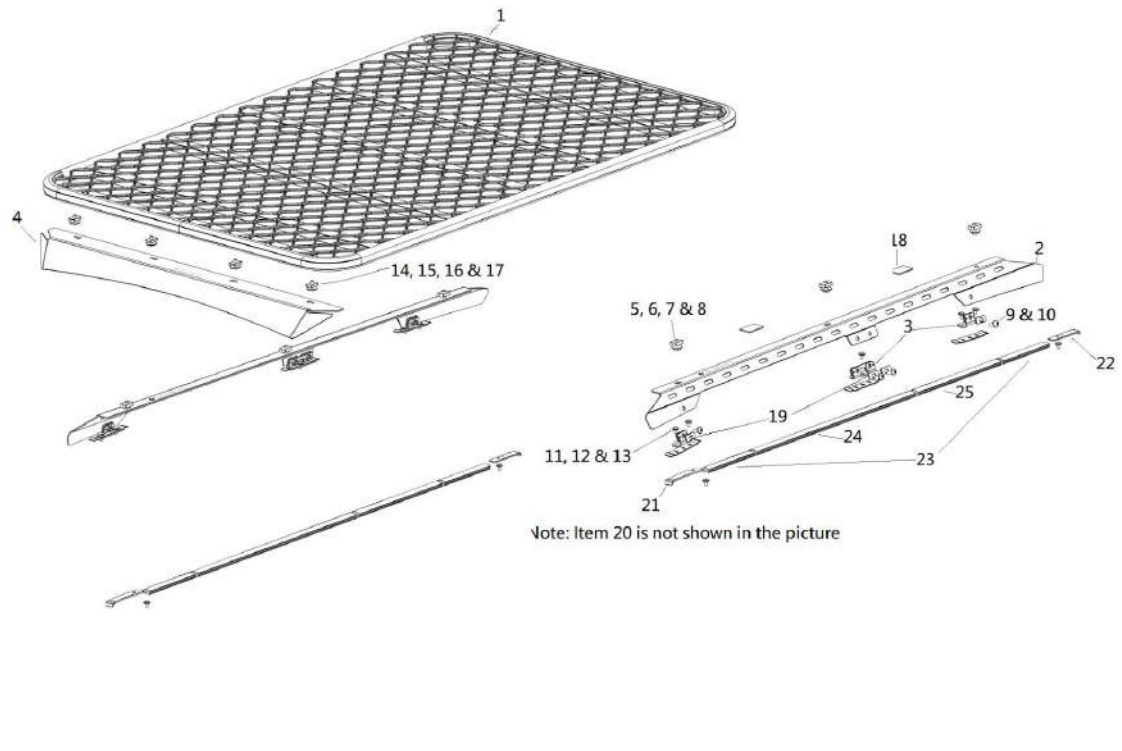

No	Item	Qty
*1	Roof Rack(TLRAL18/FT/OE)	1
2	Tough Bar X(Pair-XLB147)	1
3	X-Bracket Quick Fit (XAB147 Kit, with moulding retainer)	1
*4	Wind Deflector Kit (TLRWD13X, includes 14, 15, 16, 17 & 20)	6
Fastener Kit for Tough Bar		
5	M10 x 25mm Hex Bolt, S/S	6
6	M10 Star Washer, S/S	6
7	$\frac{3}{8}$ x $1\frac{1}{4}$, Flat washer, S/S	6
8	M10 Strut Nut,	6





Fastener Kit for X Bracket		
9	M10 x 25mm, Button Cap Socket Head Screw, S/S	8
10	$\frac{3}{8}$ x $\frac{3}{4}$, Flat Washer, S/S	8
11	M6 x 16mm(12pcs) + M6 x 18mm (2pcs)Button Cap Socket Head Screw, S/S	12+2
12	M6 Star Washer	14
13	$\frac{1}{4}$ x $\frac{3}{4}$, Flat Washer, S/S	22
Fastener Kit for Wind Deflector		
14	M8 Star Washer, S/S	4
15	M8 x 25mm Button Socket Head Screw, S/S	4
16	$\frac{5}{16}$ x $1\frac{1}{4}$, Flat washer, S/S	4
17	M8 Strut Nuts, Z/P	4
Foam Pack		
18	Acoustic Foam Tape(60x40x3mm)	4
19	Bracket Foam Pad (20x24x3mm), 2 per bracket	8
20	Acoustic Foam Tape, (1100, FS126-9)	2
MISC		
21	Front Moulding Cover	2
22	Rear Moulding Cover	2
23	Ditch Moulding (195mm)	4
24	Ditch Moulding (680mm)	2
25	Ditch Moulding (355mm)	2

Note: *1 and *4 are purchased separately.

14, 15, 16, 17 & 20 are provided with Wind Deflector Kit.

3 comprises of 6 moulding retainer, 2 x center brackets, 4 x Fr/Rr Brackets

Tools required
4mm Hexagon Wrench/Key, M6
5mm Hexagon Wrench/Key, M8
6mm Hexagon Wrench/Key, M10
10mm Socket
Size 17mm Spanner
Measuring Tape

Recommended Torque Setting for fasteners	
M6	
M8	
M10	

Step 1: Removal of Factory Fitted Rail

- Use a pry tool to remove the front and the rear rail cover.



- Remove the centre cover with a small flat head screwdriver.
 - Insert a small flat head screw driver into the slot
 - Once in contact with the inner catch, move the handle of the screwdriver toward the center of the roof to release the cover
 - Remove the Centre Rail Cap with your finger once it pop out from the hole

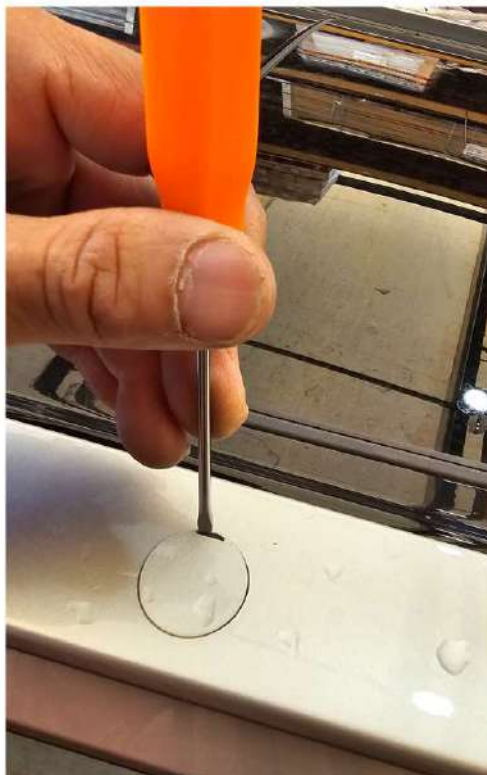

- Remove all the M6 factory fitted bolts with 10mm socket



← Front Rail Mounting



← Middle Mount



← Rear Rail Mounting

- Once all the 7 bolts are removed, lift the entire rail upward to remove from the vehicle's roof.
- Repeat the process for the opposite rail.
- Clean the ditches and get ready for the installation of the X-brackets.

Step 2: Installation of X-Bracket Kit and Roof Moulding

- Fit the Bracket Foam Padding as shown below:



- Install the X-bracket Kit and Roof Moulding as shown below:
Front segment of the vehicle:

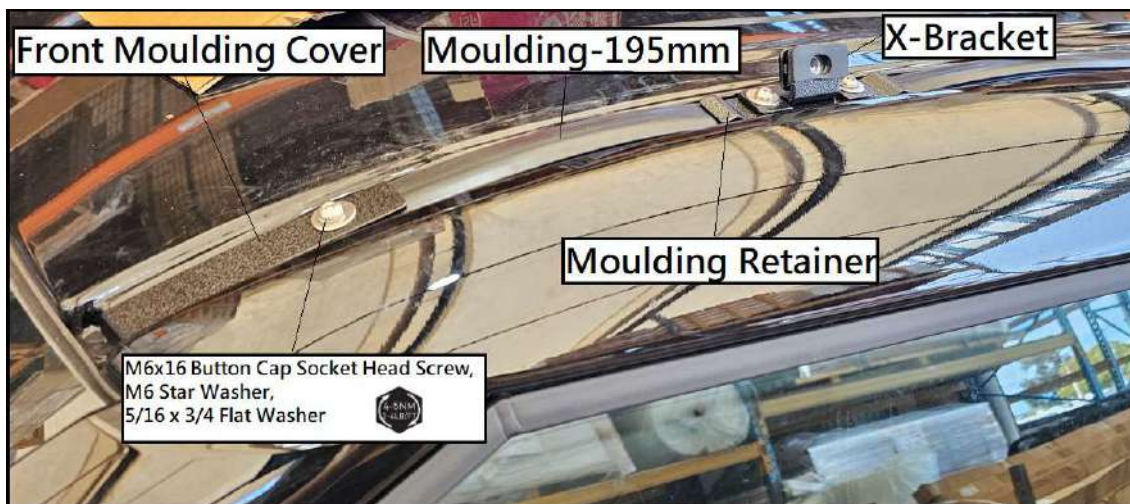

- Sequence of installation:

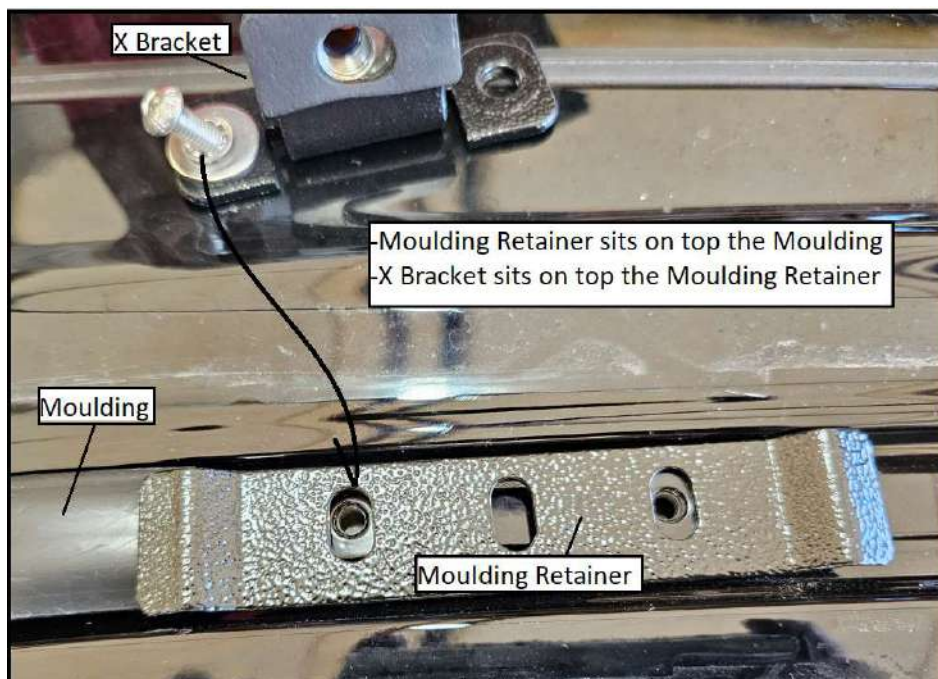

- Location of the X-brackets and Moulding Trims on the vehicle's ditches.

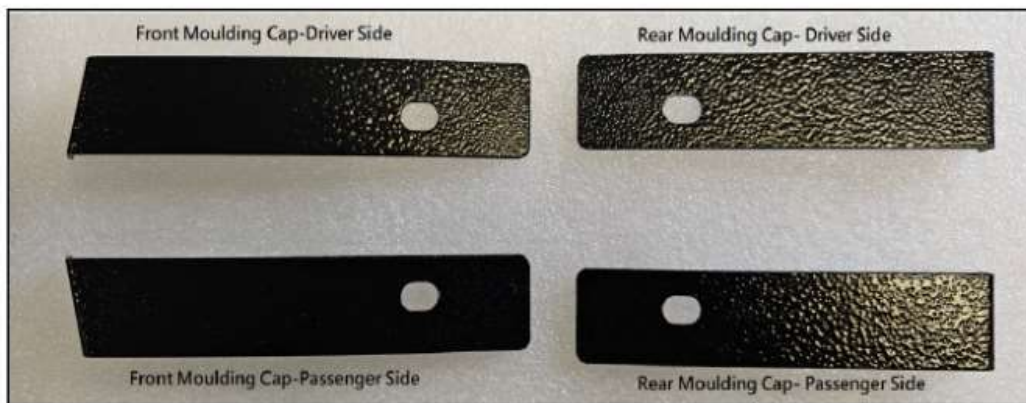
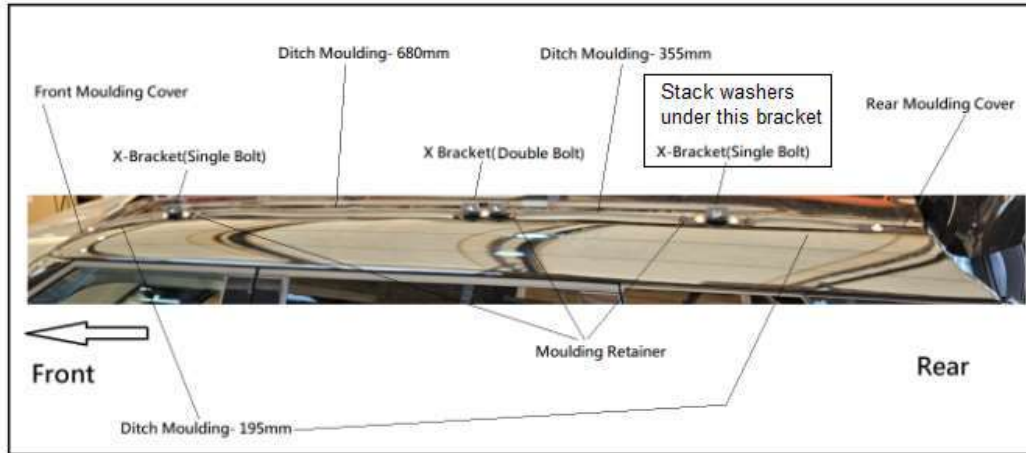

- M6 x 20mm Button Cap Socket Head Screws should only be used on the pair of rear most X Brackets
- Stack 2 pcs of $\frac{1}{4}$ x $\frac{3}{4}$ Flat Washer under the rear most mounting holes on the vehicle's roof before installing the Rear Moulding Cap. (This is to raise the height of the Leg bar to sit higher at the rear.)

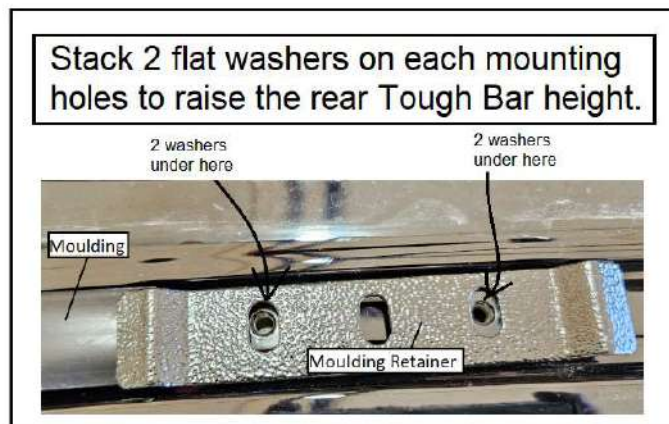

Step 3: Setting up Tough Bars onto Roof Rack

- Install the M10 Strut Nut and M10 bolt into their respective location onto the top Tough Bar as shown:

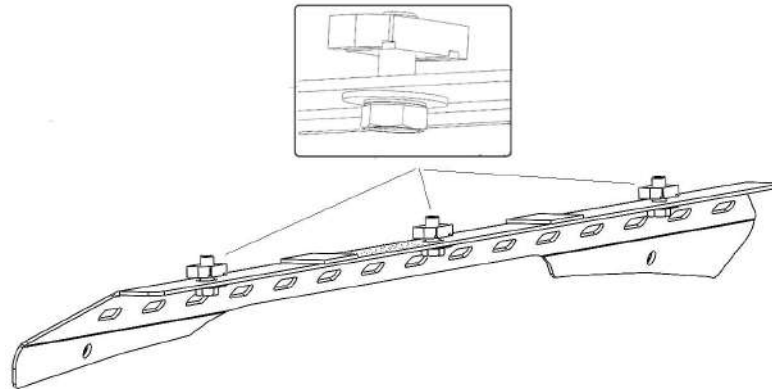

*For illustration of the installation of strut nut, not the actual Toughbar for Mitsubishi Outlander.

- Place the roof rack on a flat surface with the open side of the channel cross members facing upward.

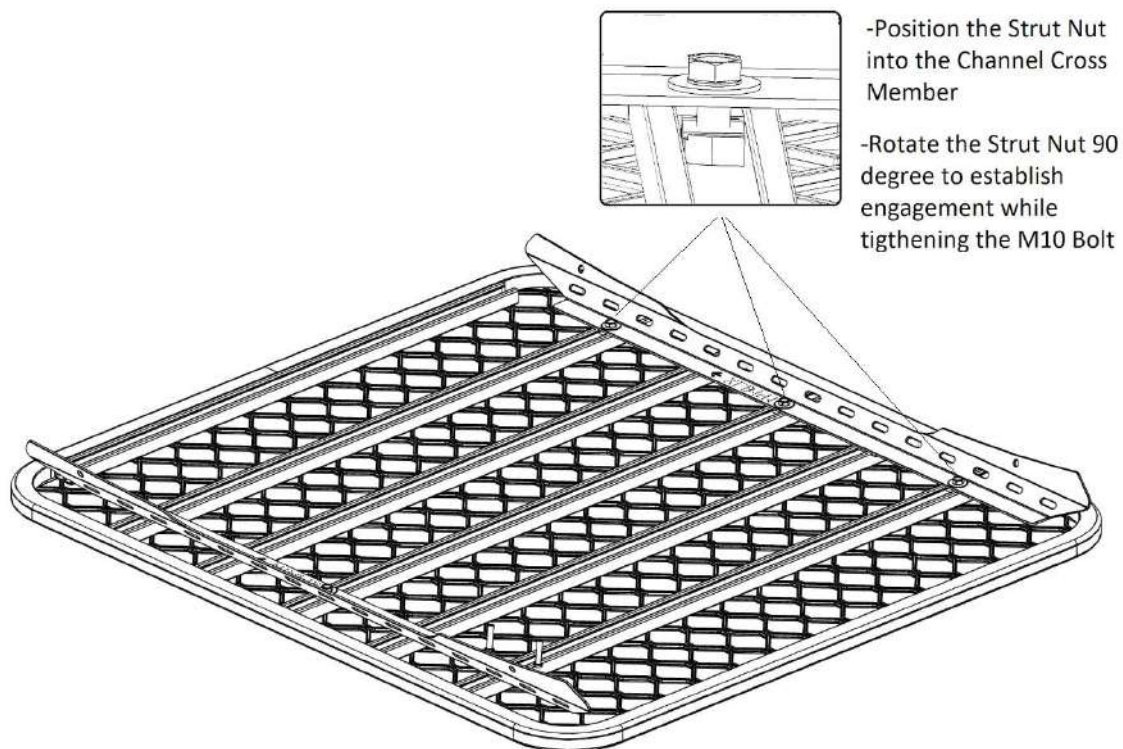

- Adjust the Tough Bar according to the distance specified below. Centralise before securing the Tough Bar firmly in position.

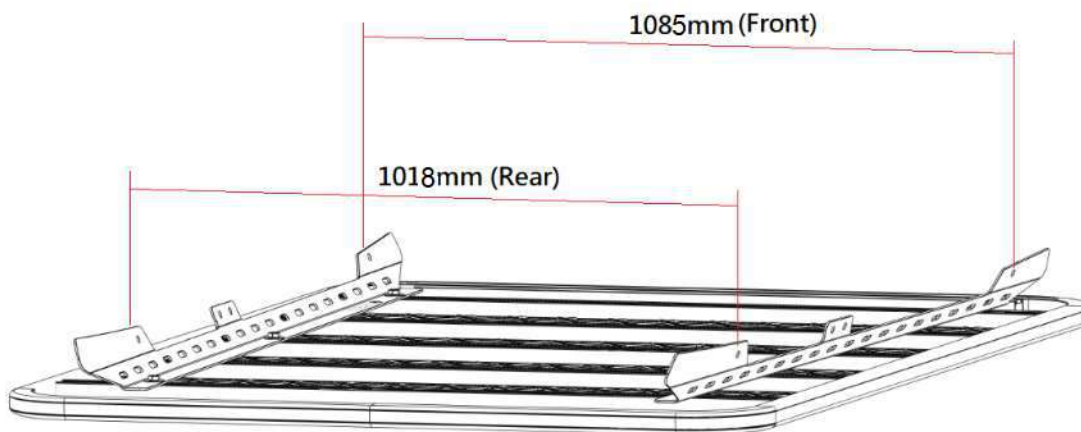
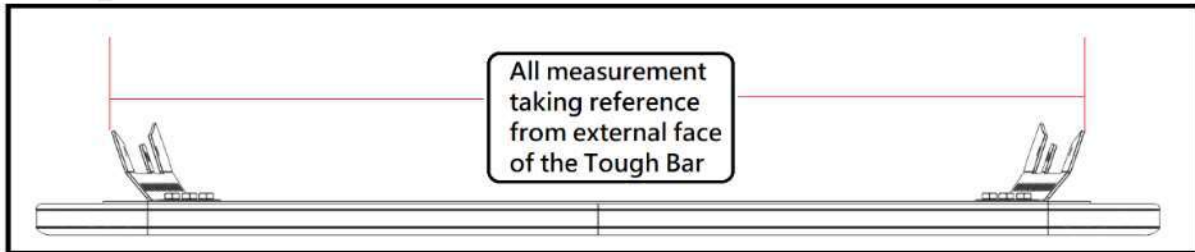

Step 4: Installation of Wind-deflector(TLRWD13X)

- Apply Acoustic Foam Tape on to the Roof Rack Frontal Area

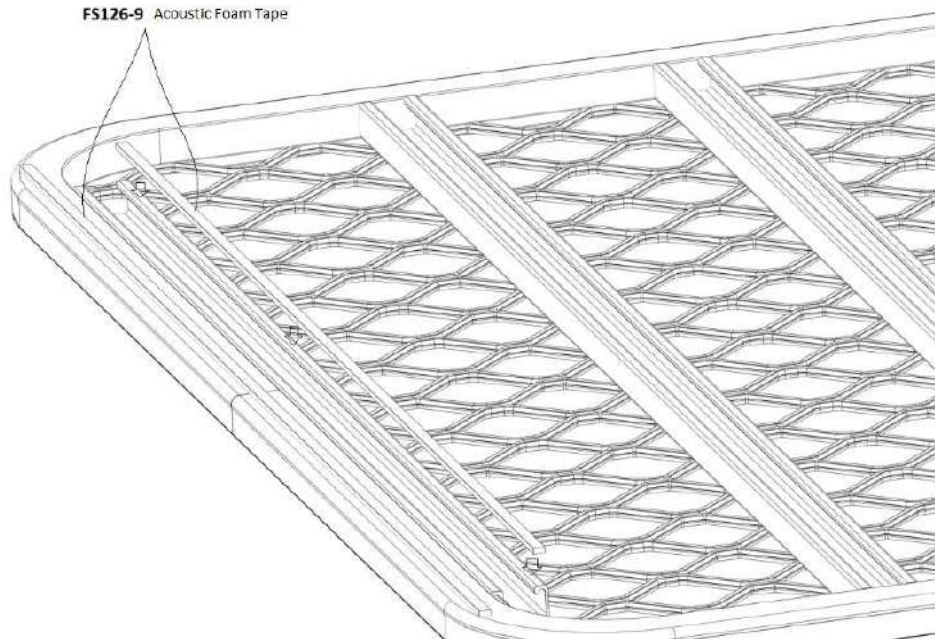

- Secure the Wind-deflector onto the front of the rack as per the illustration shown below:

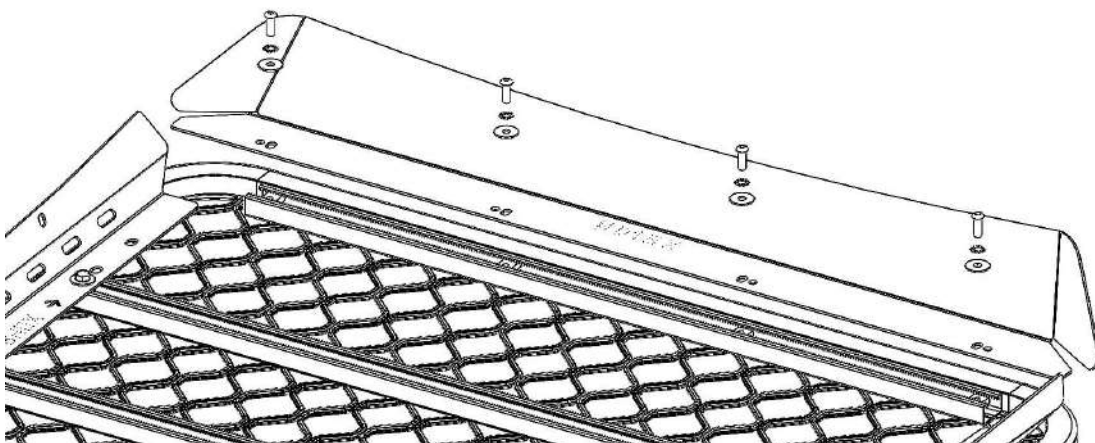

- Centralised and tightened.

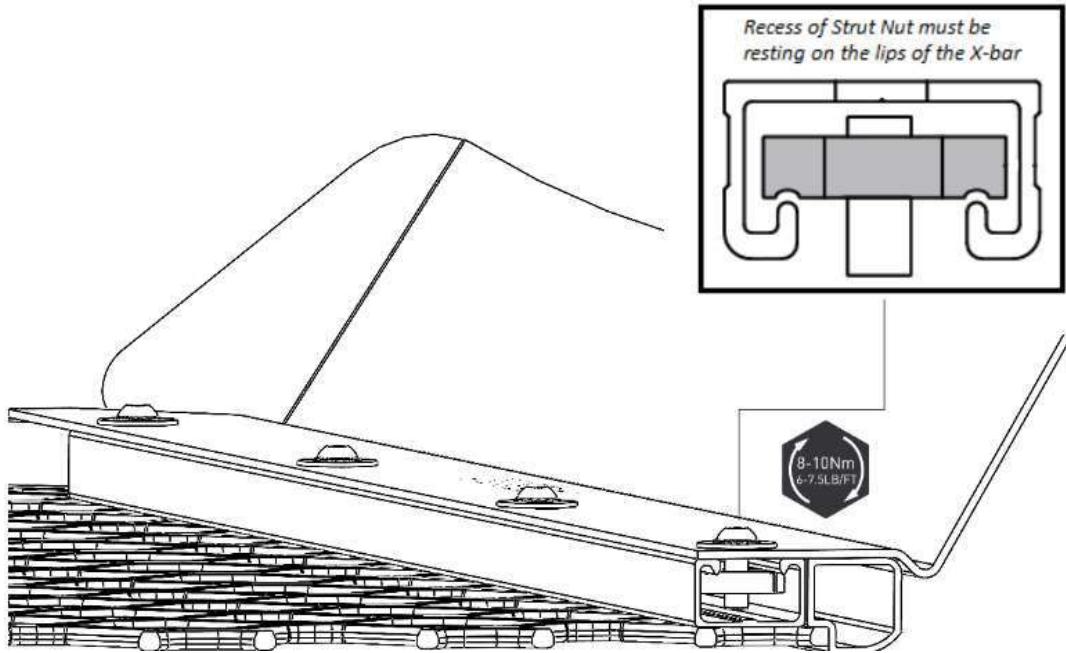

Step 5: Installation of Roof-rack assembly onto the X-Bracket.

- With a person either side of the Roof Rack, carry the Roof Rack over the rear of the vehicle and rest the Tough Bar gently over the X Brackets and align the hole centres with brackets.



- Fit the M10x25 Button Cap Socket Screw with $\frac{3}{8}$ x $\frac{3}{4}$ Flat Washer through the holes and tighten to 10-12Nm (7-9lbs/ft)

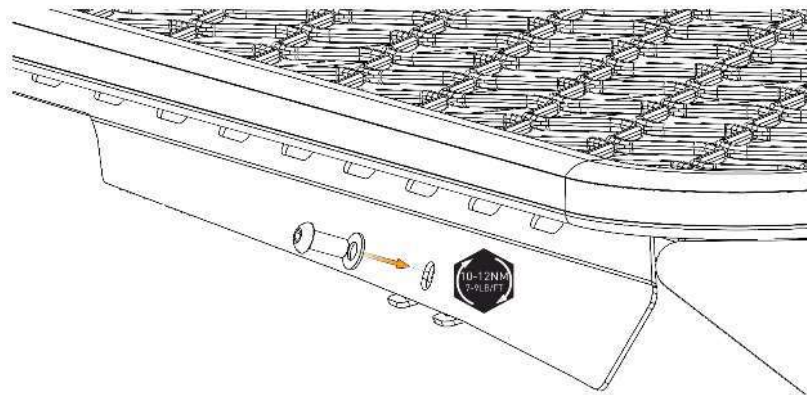

- Check to ensure that all fasteners are fully secured.
- The installation is now completed and ready to be used.

SAFETY

- Cargo must be secured firmly onto the Roof Rack during operation at all times.
- Frequently check the tightness of cargo on the Roof Rack, especially when travelling over rough terrain or off-road
- Use only non-stretchable fastening ropes or straps to attach cargo onto the Roof Rack.
- Extreme care must be taken in off road conditions.

MAINTENANCE

- All bolted connections should be checked after driving a short distance when you first install your roof racks
- All bolted connections should be checked at regular intervals, depending on road conditions, usage, loads and distances travelled
- All bolted connections should be checked each time they are re-fitted.



IMPORTANT WARNING!

IT IS CRITICAL THAT ALL TRACKLANDER 4WD ROOF RACK PRODUCTS BE PROPERLY AND SECURELY ASSEMBLED AND ATTACHED TO YOUR VEHICLE. IMPROPER ATTACHMENT COULD RESULT IN AN VEHICLE ACCIDENT, AND COULD CAUSE SERIOUS BODILY INJURY OR DEATH. YOU ARE RESPONSIBLE FOR ASSEMBLING AND SECURING ALL TRACKLANDER 4WD ROOF RACK PRODUCTS TO YOUR VEHICLE, CHECKING THE ATTACHMENTS PRIOR TO USE, AND PERIODICALLY INSPECTING THE PRODUCTS FOR ADJUSTMENT, WEAR AND TEAR. THEREFORE, YOU MUST READ AND UNDERSTAND ALL OF THE INSTRUCTIONS AND PRECAUTIONS SUPPLIED WITH YOUR TRACKLANDER 4WD ROOF RACK AND ACCESSORIES PRIOR TO INSTALLATION OR USE. IF YOU DO NOT UNDERSTAND ALL OF THE INSTRUCTIONS AND WARNINGS, OR IF YOU HAVE NO MECHANICAL EXPERIENCE AND ARE NOT THOROUGHLY FAMILIAR WITH THE INSTALLATION PROCEDURES, YOU SHOULD HAVE THE PRODUCT INSTALLED BY A PROFESSIONAL INSTALLER OR OTHER QUALIFIED PERSON.

NOTE: TRACKLANDER 4WD ROOF RACKS will not be responsible for any damage caused by the failure to install the product according to these instructions. Please call us if you have any questions about the installation of this product.

TRACKLANDER 4WD ROOF RACKS

**T : (08) 9451 0700 E :sales@tracklander.com.au W :tracklander.com.au
A:12 Railway Parade, Welshpool, WA 6106
OPEN 8.00AM - 5.00PM MON-FRI**